

Marion County Local Letting

6/17/2025 10:00 AM

L-COLINE RD26-9

Informal Bids (Bid Security: \$5,000.00)

Grading along County Line Road to flatten foreslopes and widen the road top. Also includes associated drainage pipe and structures necessary to maintain the drainage.

Lowest Responsible Bidder	Plan Holder	As Read Amount	Bid Item Total	Difference	Percent Over Low Bid	Percent of Engineer's Estimate
	Crossroads Pipe and Grading	\$58,714.00	\$58,714.00	\$0.00	\$0.00%	\$59.52%
	Van Gorp Trucking	\$86,124.00	\$86,124.00	\$0.00	\$46.68%	\$87.30%
	Sterk Excavating , Inc.	\$99,075.88	\$99,075.88	\$0.00	\$68.74%	\$100.43%
	BOULDER CONTRACTING, LLC.	\$115,346.50	\$115,346.50	\$0.00	\$96.45%	\$116.92%
	JASPER CONSTRUCTION SERVICES, INC.	\$170,910.00	\$170,910.00	\$0.00	\$191.09%	\$173.25%

Marion County Local Letting

6/17/2025 10:00 AM

L-COLINERD26-5

Informal Bids (Bid Security: \$25,000.00)

Reclamation of the existing HMA and Seal Coat and Stabilizing with Portland Cement. Placing 5 inches of HMA on the stabilized base.

Lowest Responsible Bidder	Plan Holder	As Read Amount	Bid Item Total	Difference	Percent Over Low Bid	Percent of Engineer's Estimate
	MANATT'S, INC.	\$385,678.23	\$385,678.23	\$0.00	\$0.00%	\$93.44%
	GRIMES ASPHALT AND PAVING CORPORATION	\$420,497.20	\$420,497.20	\$0.00	\$9.03%	\$101.88%
	NORRIS ASPHALT PAVING CO., LC	\$423,650.70	\$423,650.70	\$0.00	\$9.85%	\$102.64%
	INROADS, LLC.	\$429,769.10	\$429,769.10	\$0.00	\$11.43%	\$104.13%

REQUEST FOR BIDS

Project Number: L-COLINERD26-5

Bids will be accepted by the County Engineer of Marion County at their office in Knoxville, Iowa, until 10:00 AM, on Tuesday, June 17, 2025 for the various items of construction work listed below.

Plans, specifications and proposal forms for the work may be seen and may be secured at County Engineer

All proposals must be filed on the forms furnished by the County, sealed and plainly marked. Proposals containing any reservations not provided for in the forms furnished may be rejected, and the County Board reserves the right to waive technicalities and to reject any or all bids.

Attention of bidders is directed to the Special Provisions covering the qualifications of bidders and subletting or assigning of the contract.

As a condition precedent to being furnished a proposal form, a prospective bidder must be on the current Iowa Department of Transportation or local county list of qualified bidders; except that this requirement will not apply when bids are received solely for materials, supplies, or equipment.

MARION County shall issue sales tax exemption certificates through the Iowa Department of Revenue and Finance to the successful bidder and an subcontractors to enable them to purchase qualifying materials for the project free of sales tax.

Description of the Proposed Work : L-COLINERD26-5

Reclamation of the existing HMA and Seal Coat and Stabilizing with Portland Cement. Placing 5 inches of HMA on the stabilized base.

Description	Units	Quantity
FULL DEPTH RECLAMATION	SY	13896.0
MINERAL STABILIZING AGENT	TON	168.0
GRANULAR SHOULDERS, TYPE B	TON	910.000
PAVEMENT SCARIFICATION	SY	1121.000
HOT MIX ASPHALT MIXTURE, WEDGE, LEVELING OR STRENGTHENING COURSE	TON	357.300
HOT MIX ASPHALT STANDARD TRAFFIC, BASE COURSE, 3/4 IN. MIX	TON	870.60
HOT MIX ASPHALT STANDARD TRAFFIC, SURFACE COURSE, 1/2 IN. MIX, NO SPECIAL FRICTION REQUIREMENT	TON	699.900
ASPHALT BINDER, PG 58-28S, STANDARD TRAFFIC	TON	121.50
HOT MIX ASPHALT PAVEMENT SAMPLES	LS	1.00
TRAFFIC CONTROL	LS	1.00
FLAGGERS	EACH	35.000
MOBILIZATION	LS	1.00

0 Working Days; Completion Date: 9/12/2025; \$1,000.00/Day Liquidated Damages.

STANDARD SPECIFICATIONS OF THE IDOT, SERIES 2023, AND CURRENT SUPPLEMENTAL SPECIFICATIONS SHALL APPLY.

By: Tyler Christian, P.E. Marion County Engineer

BIDDING FORM FOR MARION COUNTY

Project Number: L-COLINERD26-5

Type of Work: HMA PAVEMENT AND
FULL DEPTH RECLAMATION

System: Local

Miles: 0.460

Location and Description : County Line Road - Frome Hwy 14 to 125th St

Reclamation of the existing HMA and Seal Coat and Stabilizing with Portland Cement. Placing 5 inches of HMA on the stabilized base.

Proposal of:

Name of Bidder

Street Address

City

State

Zip Code

Federal Tax I.D. Number

Phone

Fax

Email

The bidder hereby certifies that no other principal is involved in or has an interest in this proposal; that the bidder has thoroughly examined the plans and specifications and this contract form and is aware of the provisions contained herein; that the bidder has examined the site of the work and understands that the quantities of work required by the plans and specifications are approximate only and are subject to increases and decreases; that the bidder understands that all quantities of work actually required must be performed and that payment therefore shall be at the unit prices stipulated herein; that the bidder proposes to timely furnish the specified material in the quantities required and to furnish the machinery, equipment, labor and expertise necessary to competently complete this project by the time specified; that no state or county official or employee has a direct or indirect interest in the contract which would cause violation of Iowa Code Section 314.2; that the bidder has made no agreement with any supplier of motor fuel or special fuel which will result in a violation of Iowa Code Section 452A.17(8).

If this bid is accepted, Bidder agrees: to perform all "extra work" required to complete the project at unit prices or lump sums to be agreed upon in writing prior to commencement of such "extra work" or if prior agreement cannot be reached, to perform the work on a "force-account basis" as provided in the specifications; to execute the formal contract within thirty days of the date of approval for award or to forfeit the proposal guaranty furnished herewith; to begin work in accordance with the contract documents and to either complete the work within the contract period.

Work Days	Date Type	Date	Liquidated Damages Per Day
N/A	Completion Date	9/12/2025	\$1,000.00
Proposal Guaranty: \$25,000.00			

The signing of this Bid Document shall serve as an unsworn declaration that, I (the owner, partner, President, other corporate officer, or an authorized representative) hereby certify under penalty of perjury under the laws of the United States and the State of Iowa that I have read, understand, and accept the Bidding Certifications and other provisions contained in this Proposal Notice.

Signature

Date

Signature

Date

Date of Letting: Tuesday, June 17, 2025 10:00 AM, Engineer's Office, Knoxville, Iowa

SCHEDULE OF PRICES -- PROPOSAL
Marion County, Iowa -- Project L-COLINERD26-5

Type of work : HMA PAVEMENT AND FULL DEPTH RECLAMATION

UNIT PRICES AND EXTENDED AMOUNTS MUST BE TYPED OR SHOWN IN INK OR THE BID WILL BE REJECTED.

Bidder shall show unit price and extension for each item and total for each division.

Item Number	Description	Units	Quantity	Unit Price	Total
Division 1					
1. 2116 - 0000100	FULL DEPTH RECLAMATION	SY	13896.0		
2. 2116 - 0000300	MINERAL STABILIZING AGENT	TON	168.0		
3. 2121 - 7425020	GRANULAR SHOULDERS, TYPE B	TON	910.000		
4. 2214 - 5145150	PAVEMENT SCARIFICATION	SY	1121.000		
5. 2303 - 0001000	HOT MIX ASPHALT MIXTURE, WEDGE, LEVELING OR STRENGTHENING COURSE	TON	357.300		
6. 2303 - 1031750	HOT MIX ASPHALT STANDARD TRAFFIC, BASE COURSE, 3/4 IN. MIX	TON	870.60		
7. 2303 - 1033500	HOT MIX ASPHALT STANDARD TRAFFIC, SURFACE COURSE, 1/2 IN. MIX, NO SPECIAL FRICTION REQUIREMENT	TON	699.900		
8. 2303 - 1258283	ASPHALT BINDER, PG 58-28S, STANDARD TRAFFIC	TON	121.50		
9. 2303 - 6911000	HOT MIX ASPHALT PAVEMENT SAMPLES	LS	1.00		
10. 2528 - 8445110	TRAFFIC CONTROL	LS	1.00		
11. 2528 - 8445113	FLAGGERS	EACH	35.000		
12. 2533 - 4980005	MOBILIZATION	LS	1.00		
Total Bid					

The County, in accordance with Title VI of the Civil Rights Act of 1964, 78 Stat. 252, 42 U.S.C. 2000d to 2000d-4 and Title 49, Code of Federal Regulations, Department of Transportation, Subtitle A, Office of the Secretary, Part 21, Nondiscrimination in Federally-assisted programs of the Department of Transportation issued pursuant to such Act, hereby notifies all bidders that it will affirmatively insure that in any contract entered into pursuant to this advertisement, minority business enterprises will be afforded full opportunity to submit bids in response to this invitation and will not be discriminated against on the grounds of race, color, or national origin in consideration for an award.

STANDARD SPECIFICATIONS OF THE IDOT, SERIES 2023, AND CURRENT SUPPLEMENTAL SPECIFICATIONS SHALL APPLY.

REQUEST FOR BIDS

Project Number: L-COLINE RD26-9

Bids will be accepted by the County Engineer of Marion County at their office in Knoxville, Iowa, until 10:00 AM, on Tuesday, June 17, 2025 for the various items of construction work listed below.

Plans, specifications and proposal forms for the work may be seen and may be secured at County Engineer

All proposals must be filed on the forms furnished by the County, sealed and plainly marked. Proposals containing any reservations not provided for in the forms furnished may be rejected, and the County Board reserves the right to waive technicalities and to reject any or all bids.

Attention of bidders is directed to the Special Provisions covering the qualifications of bidders and subletting or assigning of the contract.

As a condition precedent to being furnished a proposal form, a prospective bidder must be on the current Iowa Department of Transportation or local county list of qualified bidders; except that this requirement will not apply when bids are received solely for materials, supplies, or equipment.

MARION County shall issue sales tax exemption certificates through the Iowa Department of Revenue and Finance to the successful bidder and an subcontractors to enable them to purchase qualifying materials for the project free of sales tax.

Description of the Proposed Work : L-COLINE RD26-9

Grading along County Line Road to flatten foreslopes and widen the road top. Also includes associated drainage pipe and structures necessary to maintain the drainage.

Description	Units	Quantity
TRAFFIC CONTROL	LS	1.00
MOBILIZATION	LS	1.00
Embankment In Place Widening	CY	2276.0
Storm Water Intake SW 406	EACH	3
15 Inch Roadway Pipe HDPE DW	LF	70.0
42 Inch Roadway Pipe HDPE DW	LF	110.0
48 Inch Roadway Pipe HDPE DW	LF	20.0
Perimeter Erosion Control Device 12 Inch	LF	2000.0
Reinforced Concrete Headwall	LS	1.00

15 Working Days; Late Start Date: 7/21/2025; \$500.00/Day Liquidated Damages.

STANDARD SPECIFICATIONS OF THE IDOT, SERIES 2023, AND CURRENT SUPPLEMENTAL SPECIFICATIONS SHALL APPLY.

By: Tyler Christian, P.E. Marion County Engineer

BIDDING FORM FOR MARION COUNTY

Project Number: L-COLINE RD26-9

Type of Work: Grading

System: Local

Miles: 0.460

Location and Description : County Line Road - From Hwy 14 to 125th St

Grading along County Line Road to flatten foreslopes and widen the road top. Also includes associated drainage pipe and structures necessary to maintain the drainage.

Proposal of:

Name of Bidder

Street Address

City

State

Zip Code

Federal Tax I.D. Number

Phone

Fax

Email

The bidder hereby certifies that no other principal is involved in or has an interest in this proposal; that the bidder has thoroughly examined the plans and specifications and this contract form and is aware of the provisions contained herein; that the bidder has examined the site of the work and understands that the quantities of work required by the plans and specifications are approximate only and are subject to increases and decreases; that the bidder understands that all quantities of work actually required must be performed and that payment therefore shall be at the unit prices stipulated herein; that the bidder proposes to timely furnish the specified material in the quantities required and to furnish the machinery, equipment, labor and expertise necessary to competently complete this project by the time specified; that no state or county official or employee has a direct or indirect interest in the contract which would cause violation of Iowa Code Section 314.2; that the bidder has made no agreement with any supplier of motor fuel or special fuel which will result in a violation of Iowa Code Section 452A.17(8).

If this bid is accepted, Bidder agrees: to perform all "extra work" required to complete the project at unit prices or lump sums to be agreed upon in writing prior to commencement of such "extra work" or if prior agreement cannot be reached, to perform the work on a "force-account basis" as provided in the specifications; to execute the formal contract within thirty days of the date of approval for award or to forfeit the proposal guaranty furnished herewith; to begin work in accordance with the contract documents and to either complete the work within the contract period.

Work Days	Date Type	Date	Liquidated Damages Per Day
15	Late Start Date	7/21/2025	\$500.00
Proposal Guaranty: \$5,000.00			

The signing of this Bid Document shall serve as an unsworn declaration that, I (the owner, partner, President, other corporate officer, or an authorized representative) hereby certify under penalty of perjury under the laws of the United States and the State of Iowa that I have read, understand, and accept the Bidding Certifications and other provisions contained in this Proposal Notice.

Signature

Date

Signature

Date

Date of Letting: Tuesday, June 17, 2025 10:00 AM, Engineer's Office, Knoxville, Iowa

SCHEDULE OF PRICES -- PROPOSAL
Marion County, Iowa -- Project L-COLINE RD26-9

Type of work : Grading

UNIT PRICES AND EXTENDED AMOUNTS MUST BE TYPED OR SHOWN IN INK OR THE BID WILL BE REJECTED.

Bidder shall show unit price and extension for each item and total for each division.

Item Number	Description	Units	Quantity	Unit Price	Total
Division 1					
1. 2528 - 8445110	TRAFFIC CONTROL	LS	1.00		
2. 2533 - 4980005	MOBILIZATION	LS	1.00		
3. 2599 - 9999003	Embankment In Place Widening	CY	2276.0		
4. 2599 - 9999005	Storm Water Intake SW 406	EACH	3		
5. 2599 - 9999009	15 Inch Roadway Pipe HDPE DW	LF	70.0		
6. 2599 - 9999009	42 Inch Roadway Pipe HDPE DW	LF	110.0		
7. 2599 - 9999009	48 Inch Roadway Pipe HDPE DW	LF	20.0		
8. 2599 - 9999009	Perimeter Erosion Control Device 12 Inch	LF	2000.0		
9. 2599 - 9999010	Reinforced Concrete Headwall	LS	1.00		
Total Bid					

The County, in accordance with Title VI of the Civil Rights Act of 1964, 78 Stat. 252, 42 U.S.C. 2000d to 2000d-4 and Title 49, Code of Federal Regulations, Department of Transportation, Subtitle A, Office of the Secretary, Part 21, Nondiscrimination in Federally-assisted programs of the Department of Transportation issued pursuant to such Act, hereby notifies all bidders that it will affirmatively insure that in any contract entered into pursuant to this advertisement, minority business enterprises will be afforded full opportunity to submit bids in response to this invitation and will not be discriminated against on the grounds of race, color, or national origin in consideration for an award.

STANDARD SPECIFICATIONS OF THE IDOT, SERIES 2023, AND CURRENT SUPPLEMENTAL SPECIFICATIONS SHALL APPLY.

Project Number L-COLINERD26-5

Division	Item Number	Description	Units	Precision	Quantity	Engineer's Estimate	Extended Amount
Division 1	2116-0000100	FULL DEPTH RECLAMATION	SY	1	13896	6.25	86,850.00
	2116-0000300	MINERAL STABILIZING AGENT	TON	1	168	175	29,400.00
	2121-7425020	GRANULAR SHOULDERS, TYPE B	TON	3	910	32	29,120.00
	2214-5145150	PAVEMENT SCARIFICATION	SY	3	1121	4	4,484.00
	2303-0001000	HOT MIX ASPHALT MIXTURE, WEDGE, LEVELING OR STRENGTHENING COURSE	TON	3	357.3	70	25,011.00
	2303-1031750	HOT MIX ASPHALT STANDARD TRAFFIC, BASE COURSE, 3/4 IN. MIX	TON	2	870.6	70	60,942.00
	2303-1033500	HOT MIX ASPHALT STANDARD TRAFFIC, SURFACE COURSE, 1/2 IN. MIX, NO SPECIAL FRIC	TON	3	689.9	70	48,993.00
	2303-1258283	ASPHALT BINDER, PG 58-28S, STANDARD TRAFFIC	TON	2	121.5	625	75,937.50
	2303-6911000	HOT MIX ASPHALT PAVEMENT SAMPLES	LS	2	1	1,000.00	1,000.00
	2528-8445110	TRAFFIC CONTROL	LS	2	1	10,000.00	10,000.00
	2528-8445113	FLAGGERS	EACH	3	35	600	21,000.00
	2533-4980005	MOBILIZATION	LS	2	1	20,000.00	20,000.00
						Project Total	412,737.50

EOP Station 27+15



SCALE IN MILES



MARION COUNTY

Aerial Plan View



- BOP 00+00

EOP 27+15.

VICINITY MAP

**TYPICAL SECTION
SYMMETRICAL ABOUT CENTERLINE
STATION 0+00 to 24+05
24.05 STATIONS TOTAL PER SIDE**

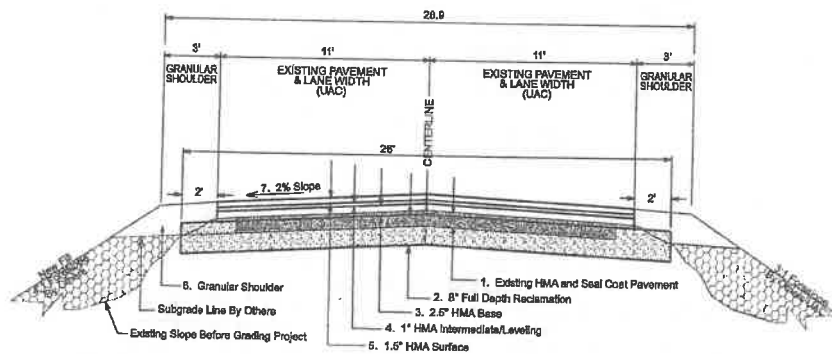

Item	Width (FT)	Depth (Inches)	Units	Quantity (per station for each lane)	Remark
Stabilized Base	26	6	SY	288.9	57.8 SY/ station both lanes Proj. Total = 13896
HMA Base	14.25	2.5	**Tons	27.58	
HMA Intermediate/Levelling	11.15	1.0	**Tons	6.97	
HMA Surface	11	1.5	**Tons	10.15	
Granular Shoulder	3	Irregular	**Tons	36.75	Irregular shoulder thickness quantity estimated

* Based on HMA unit wt of 150 PCF

** Base on unit wt of 140 PCF

NOTES:

- Existing pavement consists of approximately 4" of HMA and Seal Coat. Recycle the pavement in place to uniform gradation 1.5" and smaller. Spread, shape and to uniform slope of 2% and width of 26'.
- Full Depth Redemition is 8" in depth and includes the recycled pavement and 6" of existing subgrade material. Incorporate 6% Portland Cement and adequate water for compaction and hydration. Blade shape and compact to a uniform surface and 2% slope.
- HMA base is 2.5" in thickness. Width is 22.5' total, 11.25' each lane.
- HMA Intermediate/Levelling is nominal 1.0" thick. Width is 22.3' total, 11.15' each lane.
- HMA Surface 1.5" thickness and 22' width (11' lanes).
- Granular shoulder finished width is 3'. Place shoulder material at approximate width of 4.5' on the subgrade of the new fill and the stabilized base. The thickness is variable. The design tabulation quantity is estimated. Blade, shape and compact to final slope of 4% and to match the foreslope of the new fill place under separate contract.
- Typical crown of the final surface is 2%. The slope should be adjusted to match the existing slope at superelevation sections of the existing pavement. The engineer may adjust the slope at the time of paving if necessary.

ESTIMATED PROJECT QUANTITIES

Line Number	Item Number	Item Description	Units	Quantity	As-Built
1	2116-0000100	FULL DEPTH RECLAMATION	SY	13896	
2	2116-0000300	MINERAL STABILIZING AGENT	TON	168	
3	2121-7425020	GRANULAR SHOULDERS, TYPE B	TON	910	
4	2214-5145150	PAVEMENT SCARIFICATION	SY	1121	
5	2303-0001000	HOT MIX ASPHALT MIXTURE, WEDGE, LEVELING OR STRENGTHENING COURSE	TON	357.3	
6	2303-1031750	HOT MIX ASPHALT STANDARD TRAFFIC, BASE COURSE, 3/4 IN. MIX	TON	870.6	
7	2303-1033500	HOT MIX ASPHALT STANDARD TRAFFIC, SURFACE COURSE, 1/2 IN. MIX, NO SPECIAL FRICTION REQUIREMENT	TON	699.9	
8	2303-1258283	ASPHALT BINDER, PG 58-28S, STANDARD TRAFFIC	TON	121.5	
9	2303-6911000	HOT MIX ASPHALT PAVEMENT SAMPLES	LS	1	
10	2528-8445110	TRAFFIC CONTROL	LS	1	
11	2528-8445113	FLAGGERS	EACH	35	
12	2533-4980005	MOBILIZATION	LS	1	

REFERENCE NOTES

1	2116-0000100	FULL DEPTH RECLAMATION; Includes recycling the existing pavement in place and blading to 26' width with 2% uniform slope. Upon completion of the pavement recycling perform Full Depth Reclamation incorporating 6% Portland Cement at a depth of 8 inches and width of 26 feet. Mix the cement, recycled pavement and existing subgrade material, grade and compact to 2% slope.
2	2116-0000300	MINERAL STABILIZING AGENT; Quantity is calculated at 6% for a depth of 8 inches and unit weight of 119 PCF. Optimum moisture is estimated at 10.8%
3	2121-7425020	GRANULAR SHOULDERS, TYPE B; Quantity is estimated based on the irregular shoulder section, see typical section. Extra quantity was included for blending new HMA surface to existing granular surfaces at intersections and entrances.
4	2214-5145150	PAVEMENT SCARIFICATION; Includes milling at Hwy 14 and entrance at 25+40. Rose Lane surface notch and 125th Surface notch.
5	2303-0001000	HOT MIX ASPHALT MIXTURE, WEDGE, LEVELING OR STRENGTHENING COURSE; Quantity is included for the runout near Hwy 14. See the typical section on Sheet B.01. Certified Plant Inspection is required. No smoothness requirement.
6	2303-1031750	HOT MIX ASPHALT STANDARD TRAFFIC, BASE COURSE, 3/4 IN. MIX; Quantity is included for the runout near Hwy 14. See the typical section on Sheet B.01. Certified Plant Inspection is required. No smoothness requirement. Paving is to commence less than 36 hours after Full Depth Reclamation incorporating cement.
7	2303-1033500	HOT MIX ASPHALT STANDARD TRAFFIC, SURFACE COURSE, 1/2 IN. MIX, NO SPECIAL FRICTION REQUIREMENT; Quantity is included for the surface pavement approaching Hwy 14 and intersections. See the typical section on Sheet B.01 and Detail Sheet C.02. Certified Plant Inspection is required. No smoothness requirement.
8	2303-1258283	ASPHALT BINDER, PG 58-28S, STANDARD TRAFFIC; Quantity is calculated at 6.3% for the total HMA mix for Base, leveling, and surface.
9	2303-6911000	HOT MIX ASPHALT PAVEMENT SAMPLES;
10	2528-8445110	TRAFFIC CONTROL; Includes all signage necessary for lane closures or staggered closure option. County will provide detour signage for the closure option.
11	2528-8445113	FLAGGERS;
12	2533-4980005	MOBILIZATION;

ESTIMATED QUANTITIES

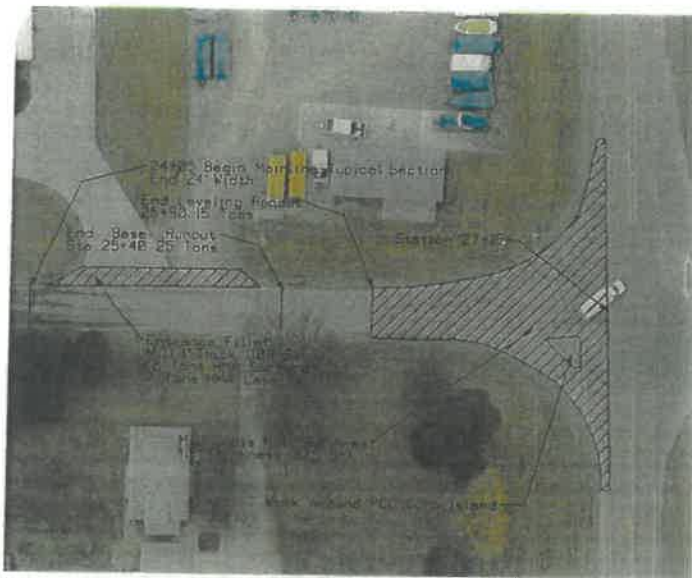

County Line 24' Width and Hwy 14

Quantities 24+05 to 27+15
Milling 934 SY
25 Tons Base
25 Tons Leveling
122 Tons Surface



Rose Lane

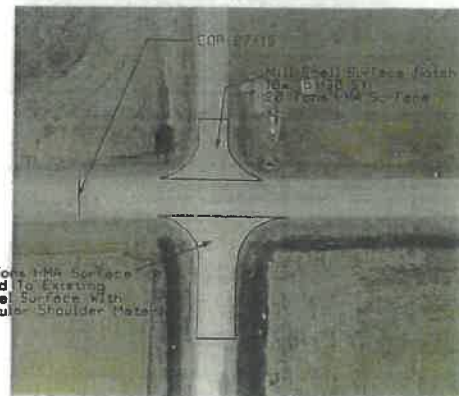

County Line and 125th

42 Tons HMA Surface
Blend To Existing
Gravel Surface With
Granular Shoulder Material

INTERSECTION DETAILS

TABULATION OF ENTRANCE AND INTERSECTION QUANTITIES											
Number	Route	Type	Side	Station	Exsting Surface	Area (SY)**	Milling (SY)**	Surface Course (tons)	Intermediate Course (tons)	Granular (tons) *	Remark
1	County Une Rd	Residential	R	25+25	HMA fillet	15		2		2	House 1296; ex. HMA fillet
2	County Une Rd	Commercial	L	24+60	HMA fillet	122	122.0	25			Combined entrance for 2 properties. Mill 1" for surface
3	County Une Rd	Commercial	L	20+80	HMA fillet	83		15		5	
4	County Une Rd	Commercial	L	18+95	Granular					8	no fillet
5	County Une Rd	F.E.	R	11+40	Granular					5	no fillet
6	County Une Rd	Residential	L	10+20	Granular					5	no fillet
7	County Une Rd	Street	L	8+35	HMA		35.6	20		5	House Lane; see detail sheet
8	County Une Rd	Commercial	L	5+95	Granular					5	no fillet
9	County Une Rd	Commercial	L	4+70	Granular					5	no fillet
10	County Une Rd	Street	L	+85	HMA Sealcoat		30	20			See detail sheet
11	County Une Rd	Street	R	+85	HMA			42		20	See detail sheet
12	County Une Rd	Street		+00	Granular					20	Transition from new HMA surface to existing granular
13	County Une Rd	Hwy 14		27+15	HMA		934	122			Mill 1.5 inch depth for the surface lift (see detail sheet)
							1121.6	246	0	75	TOTAL QUANTITIES

* Quantity is Included with the Granular Shoulder Bid Item . It is intended to provide smooth transition from new HMA surface to existing grade of the entrance.

** Quantity based on both CAD and GPS measurements

INTERSECTION QUANTITY TABULATION

LETTING DATE: June 17, 2025

MARION COUNTY L-COLINERD26-5

TRAFFIC CONTROL PLAN

TRAFFIC CONTROL SHALL BE IN ACCORDANCE WITH APPLICABLE IOWA ROAD SIGNAGE, MUTCD, MANUAL ON UNIFORM TRAFFIC CONTROL DEVICES FOR STREETS AND HIGHWAYS, AS ADOPTED BY THE DEPARTMENT PER 761 OF THE IOWA ADMINISTRATIVE CODE (IAC), CHAPTER 137, AND CURRENT STANDARD SPECIFICATIONS.

VEHICLE AND PEDESTRIAN TRAFFIC WILL BE MAINTAINED ON ALL ROUTES AT ALL TIMES. THE SUBDIVISION ON THE NORTH SIDE OF THE PROJECT HAS APPROXIMATELY 25 RESIDENTIAL PROPERTIES.

LOCAL TRAFFIC TO ADJACENT PROPERTIES WILL BE MAINTAINED AS PROVIDED FOR IN ARTICLE 1107.06 OF THE CURRENT STANDARD SPECIFICATIONS.

PROJECT COORDINATION

The project L-COLINE26-5, with a letting date of June 17, 2025, and a Late Start Date of July 21, 2025 and 15 working days allowed is a current Grading and Storm Sewer project along the same roadway segment. This roadway reconstruction project shall start as soon as possible after completion of the grading project and be substantially completed prior to September 12, 2025.

Mileage Summary / Traffic Count					
Route	Location	Station to Station	Mileage		2022 Traffic Count
County Line Rd	Hwy 34 to 125th	400	27.85	0.514	350
			0	0.000	
		TOTAL	2.715	0.514	

Vicinity Map
See Sheet A.02

IOWA DEPARTMENT OF TRANSPORTATION HIGHWAY DIVISION

PLANS FOR PROPOSED IMPROVEMENT ON THE

LOCAL SYSTEM MARION COUNTY

PROJECT NUMBER : L-COLINE RD26-5

LOCATION:
On County Line Road, from 125th St to Hwy 14

HMA Pavement - Full Depth Reclamation

Refer to the Proposal Form for a list of applicable specifications

UTILITY CONTACTS			
Company	Utility	Contact	Phone
Iowa Regional Water Association	Water		641-782-7011
Windstream	Telephone	Andy Higgins	641-528-6157
Mediacom	Cable TV	Chris Lindgren	641-542-2988
MidAmerican Energy	Gas	Jeff Ferguson	641-572-7010



6 TOTAL SHEETS

INDEX OF SHEETS

No.	Description
A.01	Title Sheet
A.02	Vicinity Map
B.01	Typical Section C-00 to 34-05
C.01	Project Quantities And Reference Notes
C.02	Intersection Details
C.03	Intersection and Entrance Tabulation/Quantities

STANDARD ROAD PLANS

Number	Date	Title
TC-1	10/15/2019	Work Affecting Traffic (Two-Lane or Multi-Lane)
TC-202	4/18/2023	Work Within 15 ft of Travelled Way
TC-211	10/15/2019	Lane Closures on Low Volume Roadway
TC-212	4/18/2023	Spot Location Lane Closures with Flaggers
TC-213	4/18/2023	Lane Closures with Flaggers
TC-214	4/18/2023	Lane Closures with Flaggers for use with Pilot Car
TC-262	4/18/2023	Routes Closed to Traffic

City of Monroe Council Members

Andrea Stearnock DATE

Vacant DATE

Andy Algreen DATE

Earl B. Umbles DATE

Jennifer St. Peter DATE

MARION COUNTY BOARD OF SUPERVISORS

JIM MUELLER DATE

STEVE MCCOMB DATE

KISHA JAHNER DATE



I hereby certify that this engineering document was prepared under my direct personal supervision and that I am a duly licensed Professional Engineer under the laws of the State of Iowa.

Signature Date

Tyler R. Christian, P.E.

Printed or Typed Name My license renewal date is December 31, 2025

Pages or sheets covered by this seal

ALL SHEETS

MARION COUNTY

L-COLINERD26-5

A.01

**TYPICAL SECTION
SYMETRICAL ABOUT CENTERLINE
STATION 0+00 to 24+05
24.05 STATIONS TOTAL PER SIDE**

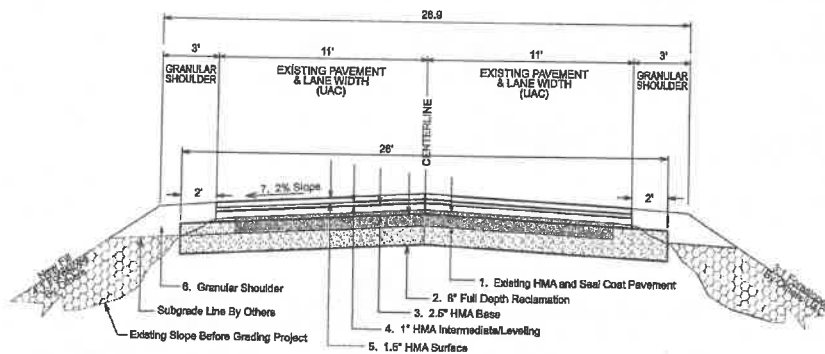

Tabulation of Design Quantities					
Item	Width (FT)	Depth (Inches)	Units	Quantity (per station for each lane)	Remark
Stabilized Base	26	8	SY	268.9	577.8 SY/ station both lanes. Total = 1155.6
HMA Base	11.25	2.5	*Tons	17.58	
HMA Intermediate/Levelling	11.15	1.0	*Tons	6.97	
HMA Surface	11	1.5	*Tons	10.31	
Granular Shoulder	3	Irregular	**Tons	18.75	Irregular shoulder thickness quantity estimated

* Based on HMA unit wt of 130 PCF

** Based on unit wt of 140 PCF

NOTES:

- Existing pavement consists of approximately 4" of HMA and Seal Coat. Recycle the pavement in place to uniform gradation 1.5" and smaller. Spread, shape and to uniform slope of 2% and width of 26'.
- Full Depth Reclamation is 8" in depth and includes the recycled pavement and 8" of existing subgrade material. Incorporate 6% Portland Cement and adequate water for compaction and hydration. Blade shape and compact to a uniform surface and 2% slope.
- HMA base is 2.5" in thickness. Width is 22.5' total, 11.25' each lane.
- HMA Intermediate/Levelling is nominal 1.0" thick. Width is 22.3' total, 11.15' each lane.
- HMA Surface 1.5" thickness and 22' width (11' lanes).
- Granular shoulder finished width is 3'. Place shoulder material at approximate width of 4.5' on the subgrade of the new fill and the stabilized base. The thickness is variable. The design tabulation quantity is estimated. Blade, shape and compact to final slope of 4% and to match the foreslope of the new fill place under separate contract.
- Typical crown of the final surface is 2%. The slope should be adjusted to match the existing slope at superelevation sections of the existing pavement. The engineer may adjust the slope at the time of paving if necessary.

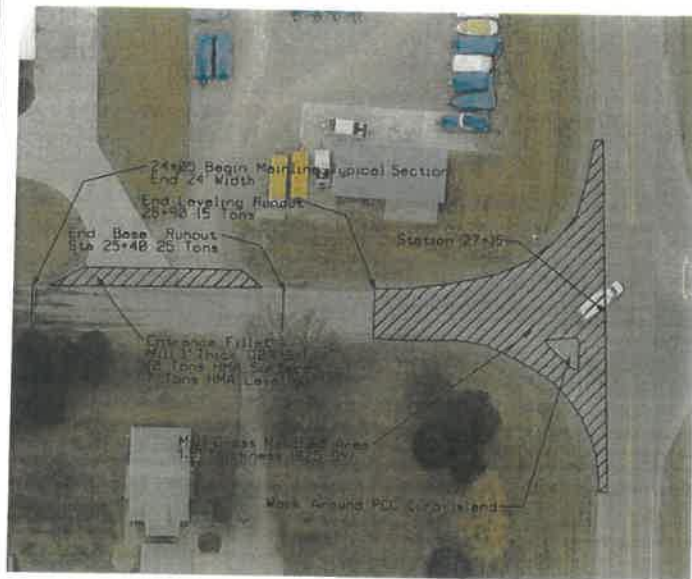

County Line 24' Width and Hwy 14

Quantities 24+05 to 27+15
 Milling 934 SY
 25 Tons Base
 25 Tons Leveling
 122 Tons Surface



Rose Lane

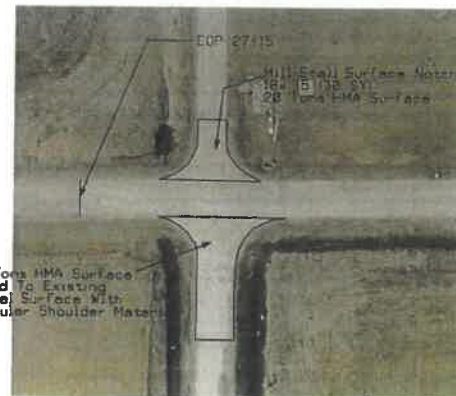

County Line and 125th

INTERSECTION DETAILS

Division	Item Number	Description	Units	Precision	Quantity	Engineer's Estimate	Extended Amount	
Division 1	2528-8445110	TRAFFIC CONTROL	LS		2	1	1,500.00	1,500.00
	2533-4980005	MOBILIZATION	LS		2	1	3,000.00	3,000.00
	2599-9999003	Embankment In Place Widening	CY		1	2276	25	56,900.00
	2599-9999005	Storm Water Intake SW 406	EACH		0	3	1,500.00	4,500.00
	2599-9999009	15 Inch Roadway Pipe HDPE DW	LF		1	70	50	3,500.00
	2599-9999009	42 Inch Roadway Pipe HDPE DW	LF		1	110	125	13,750.00
	2599-9999009	48 Inch Roadway Pipe HDPE DW	LF		1	20	150	3,000.00
	2599-9999009	Perimeter Erosion Control Device 12 Inch	LF		1	2000	3.5	7,000.00
	2599-9999010	Reinforced Concrete Headwall	LS		2	1	5,500.00	5,500.00
							Project Total	98,650.00